

Part Number: DP4-XX Y B - L

XX = N° of pins (see table below)  
 Y = T Tin plating  
 Y = S Selective gold plating  
 PCB side gold plated  
 Crimping contact tin plated

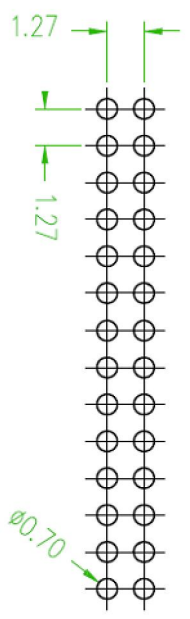

Recommended P.C.B. Layout (Top side)  
 P.C.B. Tolerance ±0,05

No. of Pins	A	B	C
06	7.90	2.54	3.175
08	9.20	3.81	4.445
10	10.50	5.08	5.715
12	11.80	6.35	6.985
14	13.10	7.62	8.255
16	14.30	8.89	9.525
20	16.90	11.43	12.065
22	18.10	12.70	13.335
26	20.70	15.24	15.875
30	23.30	17.78	18.415
34	25.80	20.32	20.955
40	29.60	24.13	24.765
44	32.10	26.67	27.305
50	35.90	30.48	31.115

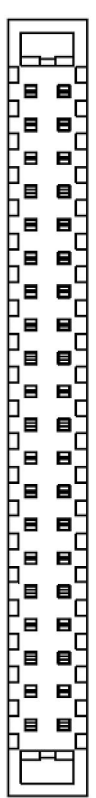
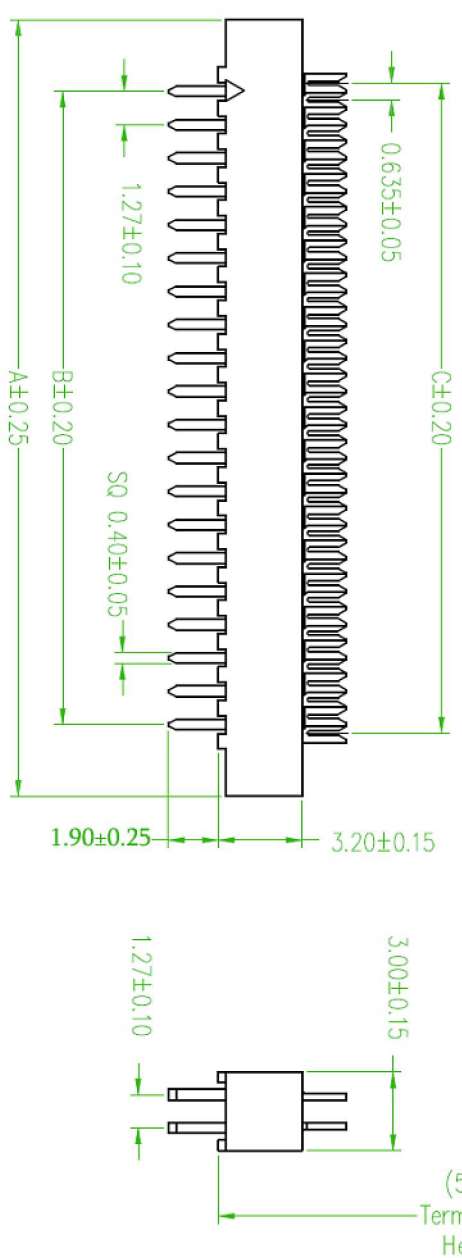
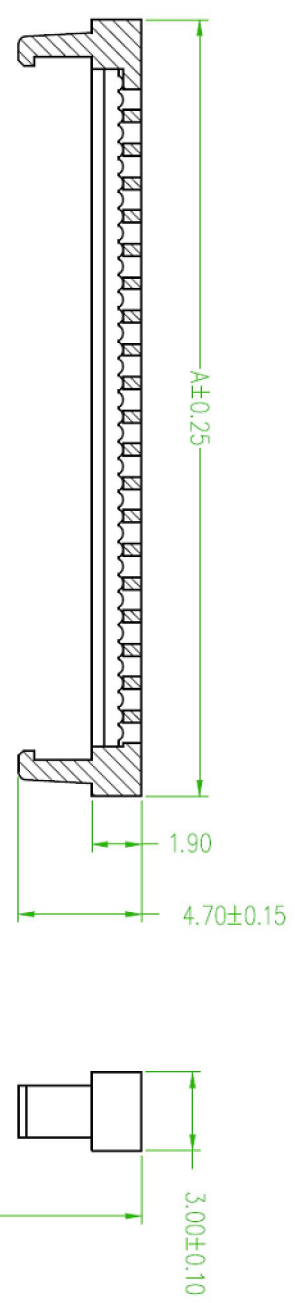

Stamp and signature for customer's agreement	Part number: DP4-XX Y B - L	Description: DIP PLUG	UNIT:mm
Drawing number: VLRC681	INDEX	DATE	MODIFICATION OCCURRED
Index: -	TOLERANCES FOR THESE DIMENSIONS ANGULAR VALUES ±2°		
Rev: VLRC681.dwg	SPECIFICATION: Current rate: 0,5 A Insulation resistance: 1000MOhm min. Contact resistance: 30mOhm max. Withstand Voltage: 1000V AC/DC Operating temperature: -40°C + +105°C Insulator: PBT 30% Glass filled UL94V-0 Contact pin: copper alloy All RoHS compliant materials		
	YMA	Scale	Date of creation: 30-01-2013
		Designer	Recordo Chiappini

