

THIS DRAWING IS THE PROPERTY OF FIORTECH FACTORY AND IT CAN NOT BE USED, REPRODUCED AND OR LOANED TO THIRD PARTIES WITHOUT THE WRITTEN PERMISSION OF FIORTECH

CM-127-D-2x (XX) -2- (YY) - A/B/C/D

(XX) = N = number of contacts between 02 and 50

Put the desired dimensions for A, B, C and D in mm unit

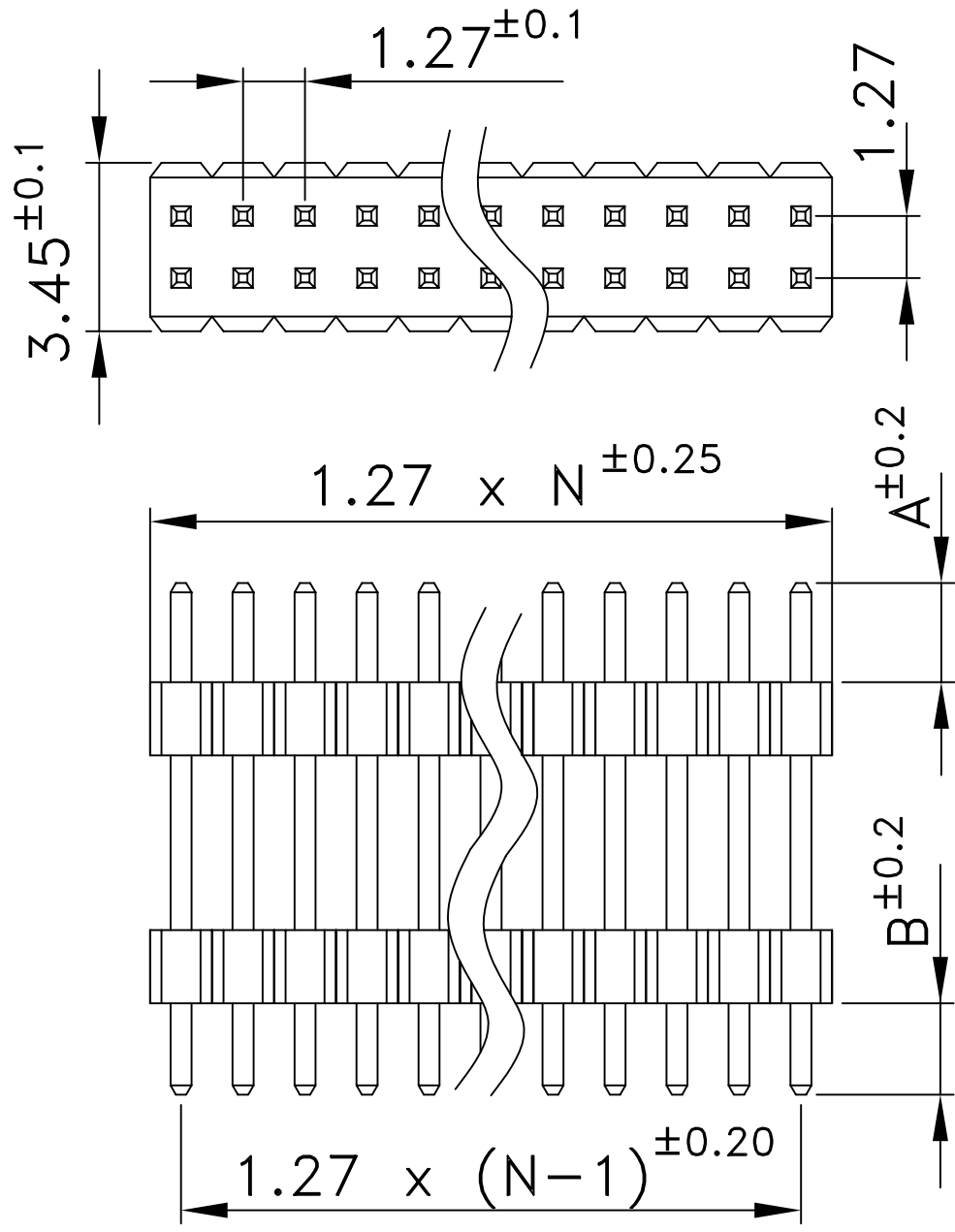

- Plating:**
- (YY) = FG = gold flash (standard)
 - ((YY)) = G1 = gold 0.12µm
 - ((YY)) = G2 = gold 0.25µm
 - ((YY)) = G3 = gold 0.50µm
 - ((YY)) = G4 = gold 0.75µm
 - ((YY)) = TF = pure tin flash
 - ((YY)) = T1 = pure tin 5µm
 - ((YY)) = FS = selective gold flash
 - ((YY)) = S1 = selective gold 0.12µm
 - ((YY)) = S2 = selective gold 0.25µm
 - ((YY)) = S3 = selective gold 0.50µm
 - ((YY)) = S4 = selective gold 0.75µm

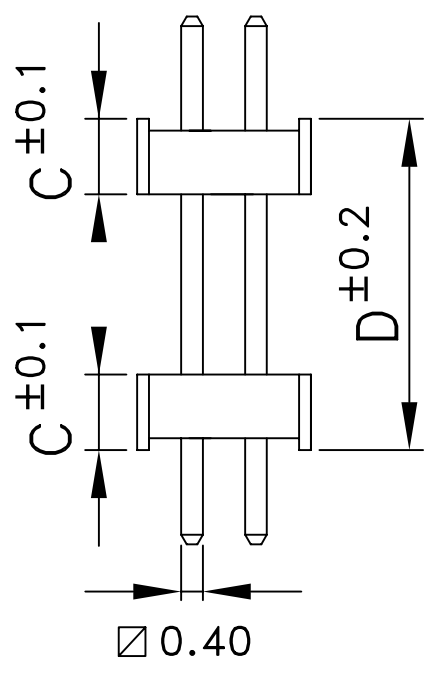

QUESTO DISEGNO È DI PROPRIETÀ DELLA DITTA FIORTECH E NON PUO' ESSERE USATO, E/O CEDUTO A TERZI SENZA IL PERMESSO SCRITTO DELLA FIORTECH

	ELECTRICAL PROPERTIES		MECHANICAL PROPERTIES		INSULATOR HEIGHT AVAILABILITY (C)																				
	Current rate: 1 Ampère Insulation resistance: 5000MΩ min. Contact resistance: 10mΩ max. Dielectric Voltage: 500V AC for 1 minute		Operating temperature: -40°C ± +105°C Peak temperature: 160° for 5+10 sec PCB recommended holes: ø0.65mm		<table border="1"> <tr> <td>1.0mm</td> <td>C=1.0</td> <td>pin</td> <td>ø0.40</td> </tr> <tr> <td>1.5mm</td> <td>C=1.5</td> <td>pin</td> <td>ø0.40</td> </tr> <tr> <td>1.7mm</td> <td>C=1.7</td> <td>pin</td> <td>ø0.40</td> </tr> <tr> <td>2.0mm</td> <td>C=2.0</td> <td>pin</td> <td>ø0.40</td> </tr> <tr> <td>2.5mm</td> <td>C=2.5</td> <td>pin</td> <td>ø0.40</td> </tr> </table>		1.0mm	C=1.0	pin	ø0.40	1.5mm	C=1.5	pin	ø0.40	1.7mm	C=1.7	pin	ø0.40	2.0mm	C=2.0	pin	ø0.40	2.5mm	C=2.5	pin
1.0mm	C=1.0	pin	ø0.40																						
1.5mm	C=1.5	pin	ø0.40																						
1.7mm	C=1.7	pin	ø0.40																						
2.0mm	C=2.0	pin	ø0.40																						
2.5mm	C=2.5	pin	ø0.40																						

INDEX	DATE	MODIFICATION OCCURRED		VISA
TOLERANCES FOR FREE DIMENSIONS				Scale
ANGULAR VALUES	FROM 0.5 TO 3.0	FROM >3.0 TO 6.0	FROM >6.0 TO 10.0	Material Pin: copper alloy (standard brass)
±2°	±0.125	±0.150	±0.180	Insulator: Nylon 6T (UL94V0)
	±0.215	±0.260	±0.310	Plating See table
	±0.370	±0.435	±0.500	Notes: --
	±0.575	±0.650		Date of creation 10-03-06
				Designer Chiappini R.

Part number: CM-127-D-2x (XX) -2- (YY) - A/B/C/D

Drawing number: _____

Index: _____

File: _____

Description: _____

Dual insulator double row straight male connector pitch 1.27mm

