

Plating:

- (YY) = FG = gold flash (standard)
- (YY) = G1 = gold 0.12µm
- (YY) = G2 = gold 0.25µm
- (YY) = G3 = gold 0.50µm
- (YY) = G4 = gold 0.75µm
- (YY) = TF = pure tin flash
- (YY) = T1 = pure tin 5µm
- (YY) = FS = selective gold flash
- (YY) = S1 = selective gold 0.12µm
- (YY) = S2 = selective gold 0.25µm
- (YY) = S3 = selective gold 0.50µm
- (YY) = S4 = selective gold 0.75µm

Put the desired dimensions for A, B and C in mm unit

If omitted, the standard is Type A

(XX) = N = number of contacts between 02 and 50

CM-200-S-1x (XX) -1- (YY) - A/B/C - Type X

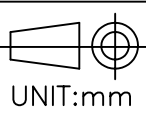

ELECTRICAL PROPERTIES
 Current rate: 1 Ampère
 Insulation resistance: 5000Ω min.
 Contact resistance: 20mΩ max.
 Dielectric Voltage: 500V AC for 1 minute

MECHANICAL PROPERTIES
 Operating temperature: -40°C + +105°C
 Peak temperature: 160° for 5±10 sec

DIMENSIONS (see also "notes")
 2.20mm ; 2.70mm
 are available for "C" dimension
 Standard "B" dimension: 4.20mm

INDEX	DATE	MODIFICATION OCCURRED	VISA Scale
-------	------	-----------------------	------------

TOLERANCES FOR FREE DIMENSIONS											
ANGULAR VALUES	FROM 0.5 TO 3.0	FROM >3.0 TO 6.0	FROM >6.0 TO 10.0	FROM >10.0 TO 18.0	FROM >18.0 TO 30.0	FROM >30.0 TO 50.0	FROM >50.0 TO 80.0	FROM >80.0 TO 120.0	FROM >120.0 TO 180.0	FROM >180.0 TO 250.0	FROM >250.0 TO 315.0
±2°	±0.125	±0.150	±0.180	±0.215	±0.260	±0.310	±0.370	±0.435	±0.500	±0.575	±0.650

Material: Pin: copper alloy
 Insulator: Nylon 6T (UL94V0)
 Position of the first pin is identified by Type A or B
 If "Type" is omitted the default standard is Type A
 Insulator height for C dimensions:
 1.5mm when C is 2.2 and 2.0mm when C is 2.7

Date of creation: 16-02-06
 Designer: Chiappini R.

Part number: CM-200-S-1x (XX) -1- (YY) -A/B/C - Type X

Drawing number: _____

Index: _____

File: _____

Description: Single row SMD male connector pitch 2.00mm

